

MAP 3 LOT 2

ACCOUNT NO.

55

BUILDING RECORD ADDRESS

CARD NO. OF

1. Conv.	5. Log	S/F BSMT LIVING	---	LAYOUT	1. Typical	2. Inadeq.	2
2. Bl Level	6. Earth Berm	FIN BSMT GRADE	---	ATTIC	1. Fl/Stairs	4. 3/4 Fin.	9
3. Split Lev.	7. Seasonal	HEAT TYPE	---	2. 1/4 Fin.	5. Full Fin.	3. 1/2 Fin.	9
4. Contemp.	8. Other	1. HW	---	INSULATION	1. Full	3. Minimal	1
		2. HW Fl.	---	2. Capped	9. None		

1. One	4. 1 1/2	COOL TYPE	---	UNFINISHED %	---	---	---
2. Two	5. 1 3/4	1. Refrig.	---	GRADE & FACTOR	1. E	5. B+	3
3. Three	6. 2 1/2	2. Evapor.	---	2. D	6. A	7. A+	100
		3. Heat Pump	---	3. C	7. A+	8. AA	100

1. Wood	5. Stucco	1. Typical	---	SO. FOOTAGE	---	---	728
2. Al/Anyl	6. Mas. Ven.	2. Inadeq.	---	CONDITION	1. Poor	5. Avg. +	4
3. Comp.	7. Masonry	3. Modern	---	2. Fair	6. Good	7. V. Good	100
4. Asb/Asp.	8. Other	9. None	---	3. Avg. -	7. V. Good	8. Exc.	100

1. Asphalt	4. Comp.	BATH(S) STYLE	---	PHYS. % GOOD	---	---	100
2. Slate	5. Wood	1. Typical	---	1. Incomp.	3. None		9
3. Metal	6. Other	3. Modern	---	2. Overbuilt	9. None		9

S/F MASONRY TRIM		# BEDROOMS	---	ECON. % GOOD	---	---	100
		# FULL BATHS	---	1. Location	3. Services	2. Encroach	9
		# HALF BATHS	---	9. None			9

YEAR BUILT	1940	# FIREPLACES	---	1. Inspect	3. Vacant	2. Refused	4. Estimate	1
YEAR REMODELED	---		---	INFO. CODE	1. Owner	4. Agent	5. Estimate	1
FOUNDATION	---		---	1. Location	3. Services	2. Encroach	9. None	9

1. Conc.	4. Wood	<p style="text-align: center;">S O F T W A R E Practical Computer Solutions C O R P O R A T I O N</p> 					
2. C. Bk.	5. Slab						
3. Br/Stone	6. Piers						

1. 1/4	4. Full	<p style="text-align: center;">S O F T W A R E Practical Computer Solutions C O R P O R A T I O N</p> 					
2. 1/2	5. Crawl						
3. 3/4	9. None						

BSMT GAR # CARS	---	<p style="text-align: center;">S O F T W A R E Practical Computer Solutions C O R P O R A T I O N</p> 					
WET BASEMENT	---						
1. Dry	3. Wet						

ADDITIONS, OUTBUILDINGS & IMPROVEMENTS							
TYPE	YEAR	UNITS	GRADE	COND.	PERCENT GOOD	PHYS.	FUNCT.
1	2010	120	---	4	100	---	100
2	2017	266	---	4	100	---	100
3	---	574	---	---	---	---	---

1. 13 Ft.	2. 28 Ft.	3. 38 Ft.	4. 1 1/2 S.F.	5. 1 3/8 S.F.	6. 2 1/2 S.F.	7. 1 1/2 S.F.	8. 1 1/2 S.F.
9. 1 1/2 S.F.	10. 1 1/2 S.F.	11. 1 1/2 S.F.	12. 1 1/2 S.F.	13. 1 1/2 S.F.	14. 1 1/2 S.F.	15. 1 1/2 S.F.	16. 1 1/2 S.F.

17. 1 1/2 S.F.	18. 1 1/2 S.F.	19. 1 1/2 S.F.	20. 1 1/2 S.F.	21. 1 1/2 S.F.	22. 1 1/2 S.F.	23. 1 1/2 S.F.	24. 1 1/2 S.F.
25. 1 1/2 S.F.	26. 1 1/2 S.F.	27. 1 1/2 S.F.	28. 1 1/2 S.F.	29. 1 1/2 S.F.	30. 1 1/2 S.F.	31. 1 1/2 S.F.	32. 1 1/2 S.F.

33. 1 1/2 S.F.	34. 1 1/2 S.F.	35. 1 1/2 S.F.	36. 1 1/2 S.F.	37. 1 1/2 S.F.	38. 1 1/2 S.F.	39. 1 1/2 S.F.	40. 1 1/2 S.F.
41. 1 1/2 S.F.	42. 1 1/2 S.F.	43. 1 1/2 S.F.	44. 1 1/2 S.F.	45. 1 1/2 S.F.	46. 1 1/2 S.F.	47. 1 1/2 S.F.	48. 1 1/2 S.F.

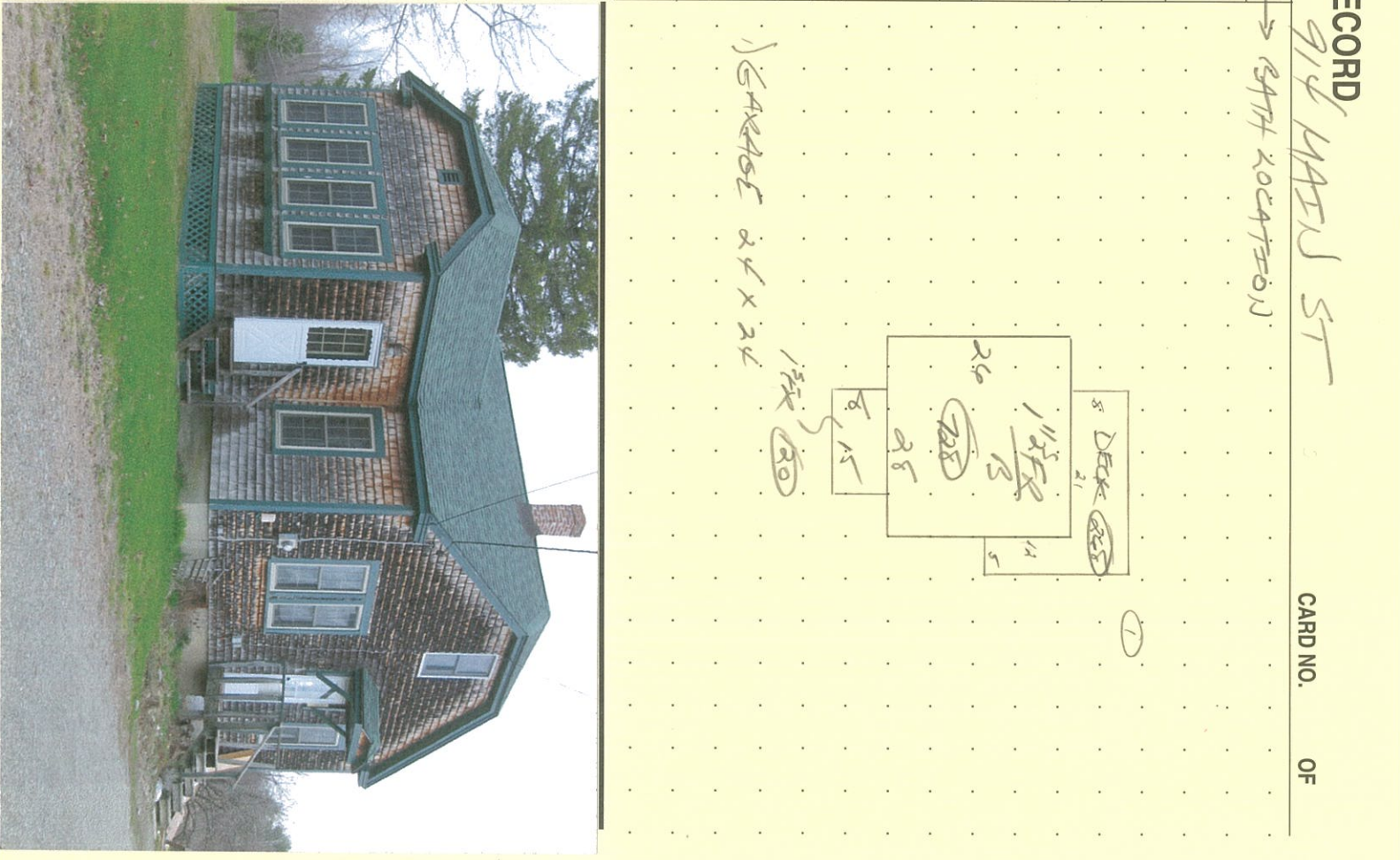

NOTES: