

MAP 15 LOT 2602 ACCOUNT NO. 347

BUILDING RECORD ADDRESS 84 MAIN ST

CARD NO. OF

| BUILDING STYLE | S/F BSMT LIVING | FIN BSMT GRADE | HEAT TYPE | COOL TYPE | BATH(S) STYLE | CONDITION | SO. FOOTAGE |
|---|--|------------------------------------|---|--|------------------------------------|--|--|
| 1. Conv. 2. Bl Level 3. Split Lev. 4. Contemp. | 5. Log 6. Earth Berm 7. Seasonal 8. Other | 1. Typical 2. Inadeq. | 1. HW 2. HW Fil. 3. Heat Pump 4. Steam | 1. Refrig. 2. Evapor. 3. Heat Pump | 1. Typical 2. Inadeq. | 1. Poor 2. Fair 3. Avg. 4. Avg. | 1. 15F 2. 25F 3. 35F 4. 1125F 5. 1345F 6. 2125F |
| OTHER UNITS | 1. HW 2. HW Fil. 3. Heat Pump 4. Steam | 1. Full 2. Capped 3. Minimal | 1. Full 2. Capped 3. Minimal | 1. Full 2. Capped 3. Minimal | 1. Full 2. Capped 3. Minimal | 1. Full 2. Capped 3. Minimal | 1. Full 2. Capped 3. Minimal |
| STORIES | 1. One 2. Two 3. Three | 1. Full 2. Capped 3. Minimal | 1. Full 2. Capped 3. Minimal | 1. Full 2. Capped 3. Minimal | 1. Full 2. Capped 3. Minimal | 1. Full 2. Capped 3. Minimal | 1. Full 2. Capped 3. Minimal |
| EXTERIOR WALLS | 1. Wood 2. AlVnly/ 3. Comp. 4. Asb/Asp. | 1. Full 2. Capped 3. Minimal | 1. Full 2. Capped 3. Minimal | 1. Full 2. Capped 3. Minimal | 1. Full 2. Capped 3. Minimal | 1. Full 2. Capped 3. Minimal | 1. Full 2. Capped 3. Minimal |
| ROOF SURFACE | 1. Asphalt 2. Slate 3. Metal | 1. Full 2. Capped 3. Minimal | 1. Full 2. Capped 3. Minimal | 1. Full 2. Capped 3. Minimal | 1. Full 2. Capped 3. Minimal | 1. Full 2. Capped 3. Minimal | 1. Full 2. Capped 3. Minimal |
| S/F MASONRY TRIM | 1. Full 2. Capped 3. Minimal | 1. Full 2. Capped 3. Minimal | 1. Full 2. Capped 3. Minimal | 1. Full 2. Capped 3. Minimal | 1. Full 2. Capped 3. Minimal | 1. Full 2. Capped 3. Minimal | 1. Full 2. Capped 3. Minimal |
| YEAR BUILT | 1932 | 1. Full 2. Capped 3. Minimal | 1. Full 2. Capped 3. Minimal | 1. Full 2. Capped 3. Minimal | 1. Full 2. Capped 3. Minimal | 1. Full 2. Capped 3. Minimal | 1. Full 2. Capped 3. Minimal |
| YEAR REMODELED | | 1. Full 2. Capped 3. Minimal | 1. Full 2. Capped 3. Minimal | 1. Full 2. Capped 3. Minimal | 1. Full 2. Capped 3. Minimal | 1. Full 2. Capped 3. Minimal | 1. Full 2. Capped 3. Minimal |
| FOUNDATION | 1. Conc. 2. C. Blk. 3. Br/Stone | 1. Full 2. Capped 3. Minimal | 1. Full 2. Capped 3. Minimal | 1. Full 2. Capped 3. Minimal | 1. Full 2. Capped 3. Minimal | 1. Full 2. Capped 3. Minimal | 1. Full 2. Capped 3. Minimal |
| BASEMENT | 1. 1/4 2. 1/2 3. 3/4 4. Full 5. Crawl 9. None | 1. Full 2. Capped 3. Minimal | 1. Full 2. Capped 3. Minimal | 1. Full 2. Capped 3. Minimal | 1. Full 2. Capped 3. Minimal | 1. Full 2. Capped 3. Minimal | 1. Full 2. Capped 3. Minimal |
| BSMT GAR # CARS | 1. Dry 2. Damp | 1. Full 2. Capped 3. Minimal | 1. Full 2. Capped 3. Minimal | 1. Full 2. Capped 3. Minimal | 1. Full 2. Capped 3. Minimal | 1. Full 2. Capped 3. Minimal | 1. Full 2. Capped 3. Minimal |
| WET BASEMENT | 1. Dry 2. Damp | 1. Full 2. Capped 3. Minimal | 1. Full 2. Capped 3. Minimal | 1. Full 2. Capped 3. Minimal | 1. Full 2. Capped 3. Minimal | 1. Full 2. Capped 3. Minimal | 1. Full 2. Capped 3. Minimal |



SOFTWARE
Practical Computer Solutions
CORPORATION

| ADDITIONS, OUTBUILDINGS & IMPROVEMENTS | UNITS | GRADE | COND. | PERCENT GOOD | DATE INSP. |
|--|-------|-------|-------|--------------|--------------|
| TYPE | YEAR | UNITS | GRADE | COND. | PERCENT GOOD |
| 22 | | 22 | | | |
| 21 | | 21 | | | |
| 20 | | 20 | | | |
| 19 | | 19 | | | |
| 18 | | 18 | | | |
| 17 | | 17 | | | |
| 16 | | 16 | | | |
| 15 | | 15 | | | |
| 14 | | 14 | | | |
| 13 | | 13 | | | |
| 12 | | 12 | | | |
| 11 | | 11 | | | |
| 10 | | 10 | | | |
| 9 | | 9 | | | |
| 8 | | 8 | | | |
| 7 | | 7 | | | |
| 6 | | 6 | | | |
| 5 | | 5 | | | |
| 4 | | 4 | | | |
| 3 | | 3 | | | |
| 2 | | 2 | | | |
| 1 | | 1 | | | |

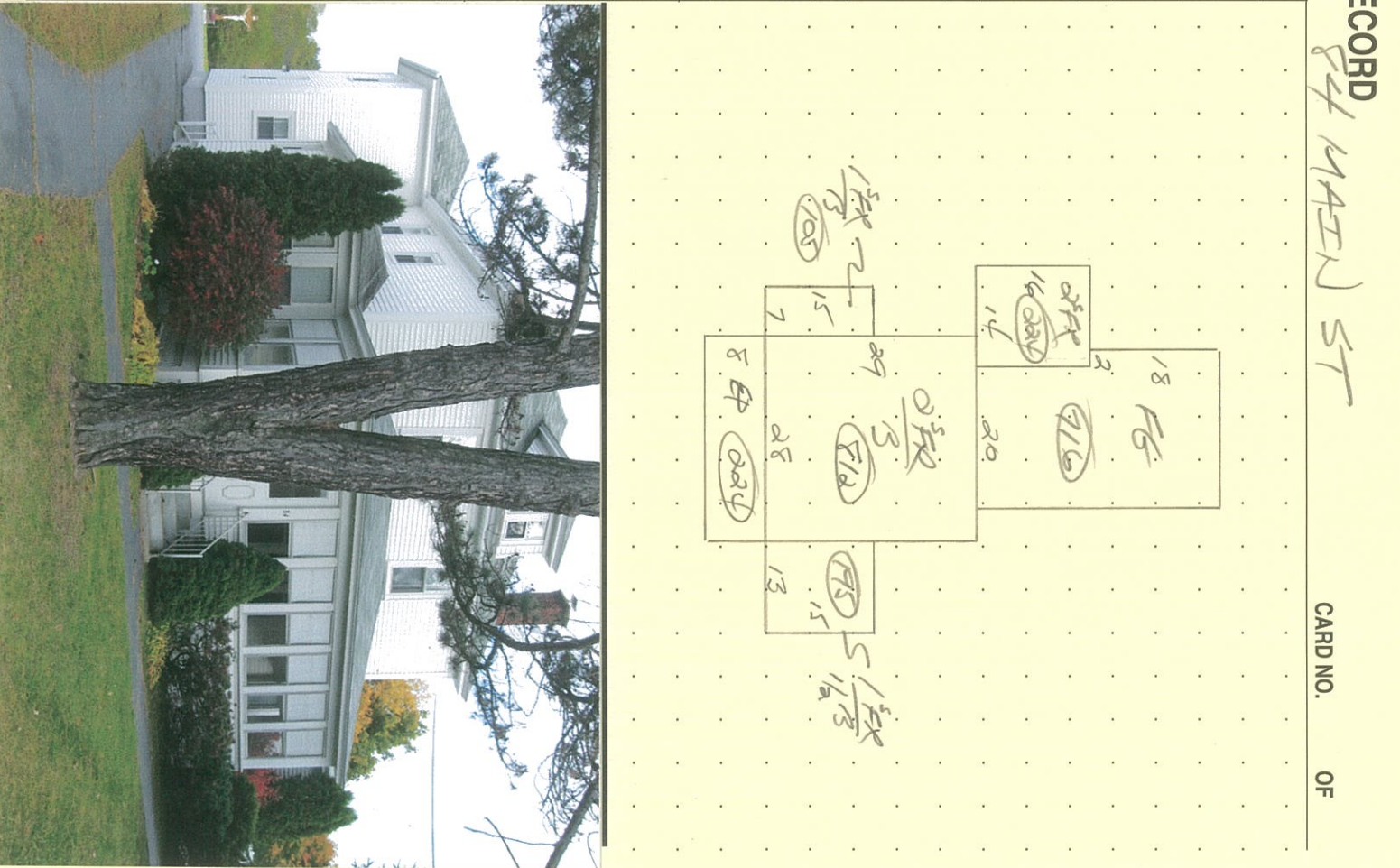

NOTES: